

SAPPA Parcel Report

Date Created: July 26, 2022

The South Australian Property and Planning Atlas is available at the Plan SA website <https://sappa.plan.sa.gov.au/>

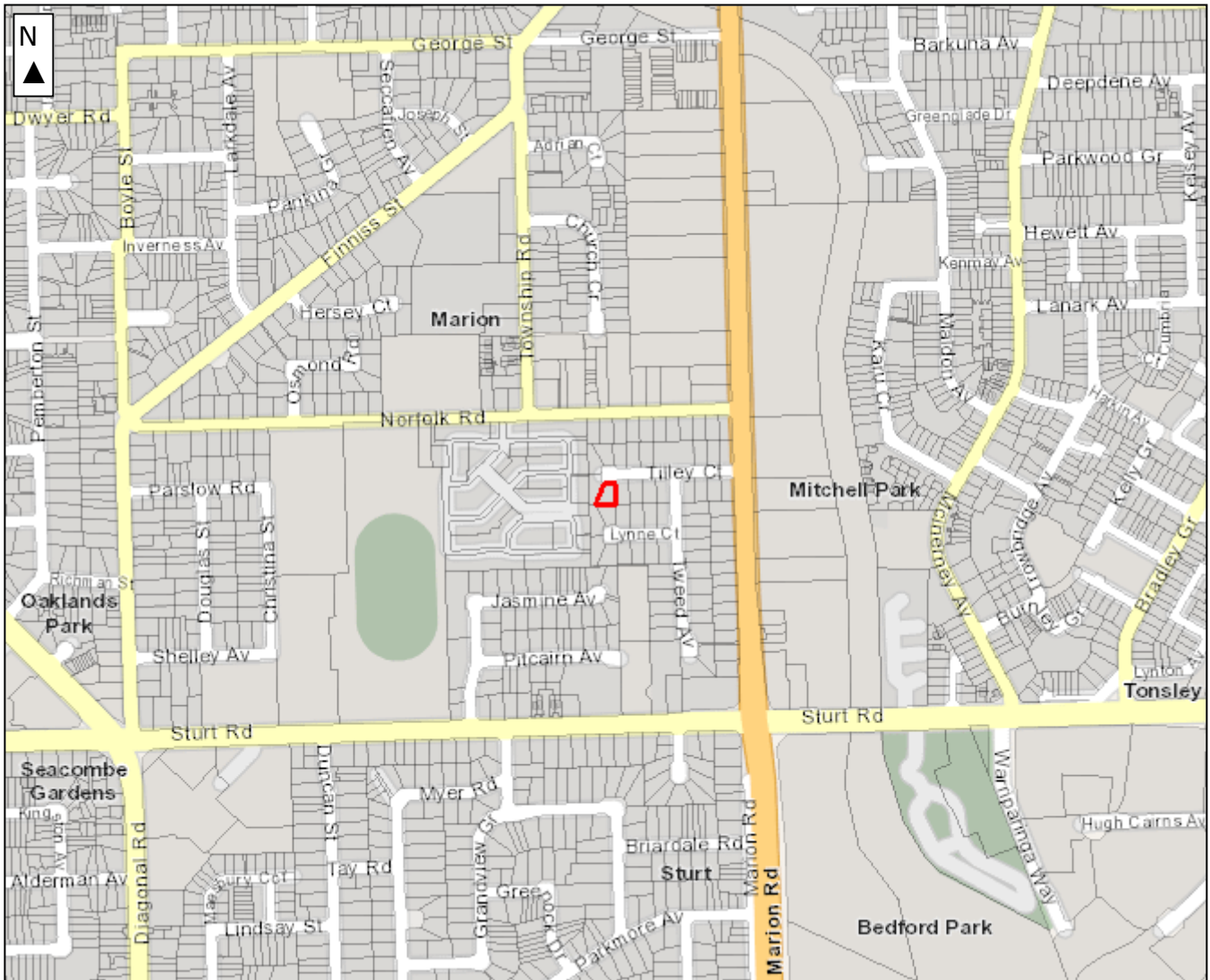

Address Details

Unit Number:
Street Number: 8
Street Name: TILLEY
Street Type: CT
Suburb: MARION
Postcode: 5043

Scale ≈ 1:9028 (on A4 page)

250 metres≈

The information provided, is not represented to be accurate, current or complete at the time of printing this report.

Property Details:

Council: CITY OF MARION
State Electorate: ELDER (2014), GIBSON (2018), GIBSON (2022)
Federal Electorate: BOOTHBY (2013), BOOTHBY (2016), BOOTHBY (2019)
Hundred: NOARLUNGA
Valuation Number: 1013824003
Title Reference: CT6130/890
Plan No. Parcel No.: D6889A19

The Government of South Australia accepts no liability for the use of this data, or any reliance placed on it.

This report and its contents are (c) copyright Government of South Australia.

Zoning details next page



Government of South Australia
 Attorney-General's Department

Zone Details

Zones

General Neighbourhood (Z2102) - GN

Overlays

Airport Building Heights (Regulated) (O0303) - All structures over 110 metres

The Airport Building Heights (Regulated) Overlay seeks to ensure building height does not pose a hazard to the operation and safety requirements of commercial and military airfields.

Affordable Housing (O0306)

The Affordable Housing Overlay seeks to ensure the integration of a range of affordable dwelling types into residential and mixed use development.

Hazards (Flooding - General) (O2414)

The Hazards (Flooding - General) Overlay seeks to minimise impacts of general flood risk through appropriate siting and design of development.

Prescribed Wells Area (O4804)

The Prescribed Wells Area Overlay seeks to ensure sustainable water use in prescribed wells areas.

Regulated and Significant Tree (O5404)

The Regulated and Significant Tree Overlay seeks to mitigate the loss of regulated trees through appropriate development and redevelopment.

Stormwater Management (O5710)

The Stormwater Management Overlay seeks to ensure new development incorporates water sensitive urban design techniques to capture and re-use stormwater.

Traffic Generating Development (O6001)

The Traffic Generating Development Overlay aims to ensure safe and efficient vehicle movement and access along urban transport routes and major urban transport routes.

Urban Tree Canopy (O6302)

The Urban Tree Canopy Overlay seeks to preserve and enhance urban tree canopy through the planting of new trees and retention of existing mature trees where practicable.